



## September Way

Stanmore

£385,000

Davidson Frost-Wellings are pleased to present this first floor flat in Mentmore Court. The property comprises two bedrooms, a bathroom and reception room with a balcony. The flat also has a garage and visitor parking.

Mentmore Court is a fantastic location with close proximity to the centre of Stanmore and its amenities and tube station, and is near to the lovely Temple Pond.

Harrow Council tax band D

Share of freehold 946 years remaining

Service charge £1800 pa

### Viewing

Please contact our Davidson Frost-Wellings Office on 020 8954 8806 if you wish to arrange a viewing appointment for this property or require further information.

- Two bedrooms
- Bathroom
- First floor
- Balcony
- Garage
- Great condition



2



1



null



C

# Floor Plan

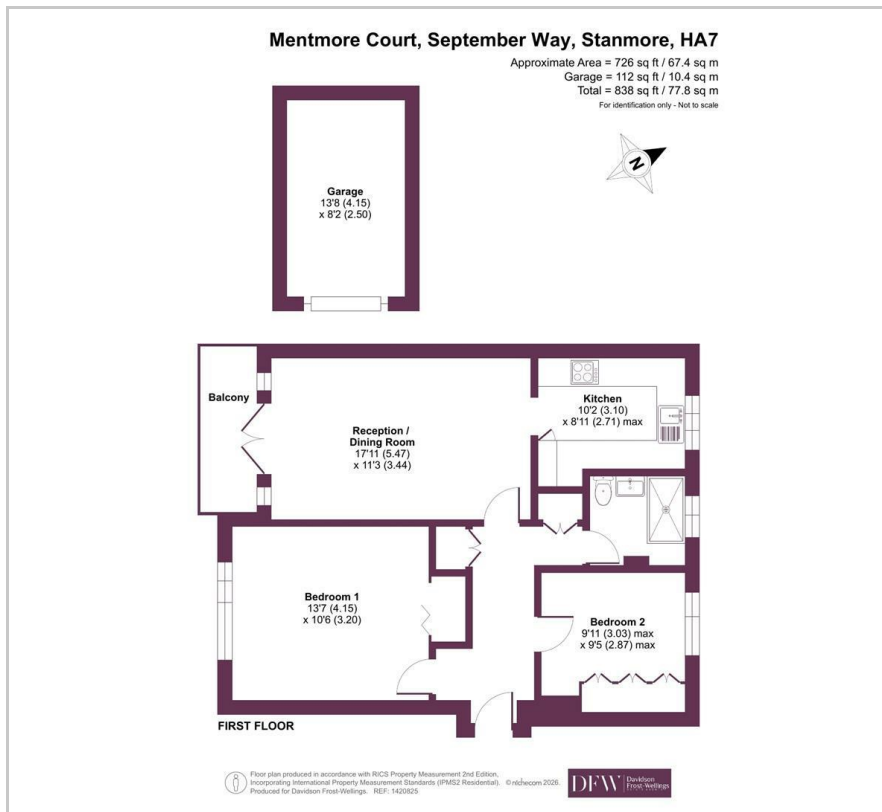

# Area Map

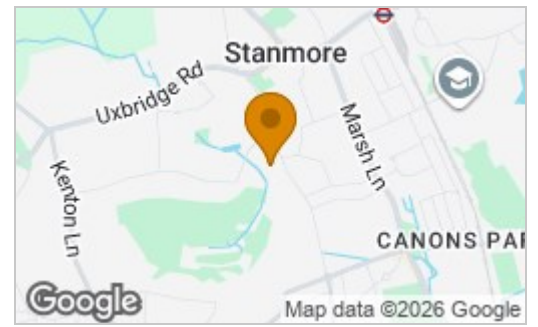

Energy Efficiency Rating		
	Current	Potential
Very energy efficient - lower running costs		
(92 plus) <b>A</b>		
(81-91) <b>B</b>		
(69-80) <b>C</b>	<b>74</b>	<b>79</b>
(55-68) <b>D</b>		
(39-54) <b>E</b>		
(21-38) <b>F</b>		
(1-20) <b>G</b>		
Not energy efficient - higher running costs		
<b>England &amp; Wales</b>	EU Directive 2002/91/EC	



These particulars, whilst believed to be accurate are set out as a general outline only for guidance and do not constitute any part of an offer or contract. Intending purchasers should not rely on them as statements of representation of fact, but must satisfy themselves by inspection or otherwise as to their accuracy. No person in this firm's employment has the authority to make or give any representation or warranty in respect of the property.